



My Visit to Carrickfergus Museum

Pre-Visit Guide Series

www.midandeastantrim.gov.uk



**Mid & East
Antrim**
Borough Council

Contents

Page Title	Page Number
Welcome to Carrickfergus Museum	4
Getting Here	5
Arriving Here	6
Finding Your Way Around	7
Ground Floor	
The Mall	8
The Community Archive	9
The Temporary Exhibition Gallery	10
Carrickfergus Museum	11
Opening Hours	15
Useful Information	16



Welcome

Welcome to Carrickfergus Museum

Everyone feels different when visiting a new place or trying something new. There are new sounds and smells, and you may not know what to expect. This guide will help you get ready for your trip.

It will:

- Tell you how to get to and enter Carrickfergus Museum.
- Introduce you to some of the people who work here.
- Explain how to find your way around.
- Show you some of the things that you can do when you visit. We are here to help.

Here are some of the staff you might meet on your visit. They are our Autism Champions. You can ask them, or any of the staff in this uniform, for help while you are with us.



Getting Here

Carrickfergus Museum is in the town centre. It is just off the A2 Shore Road at Carrickfergus Castle.

There are car parks and a bike stand beside the entrance for cyclists to use. You can get to the museum by bus or by train. You can walk from the bus stop or from the train station to get to the museum. If you go by car, you can park in a car park near the museum.



Arriving Here

This is the entrance that will take you into Carrickfergus Museum. It has sliding doors which open by themselves.

The entrance door to the museum is on the left. When you enter, you will be on the ground level in the reception area.



Finding Your Way Around

There are two floors in the building.
The Museum is the ground floor.

This is colour-coded on the map below, and throughout this guide. There are staircases, ramps and lifts to help you get around the various parts of the building. There is plenty of signage and staff will always be happy to help you find your way.

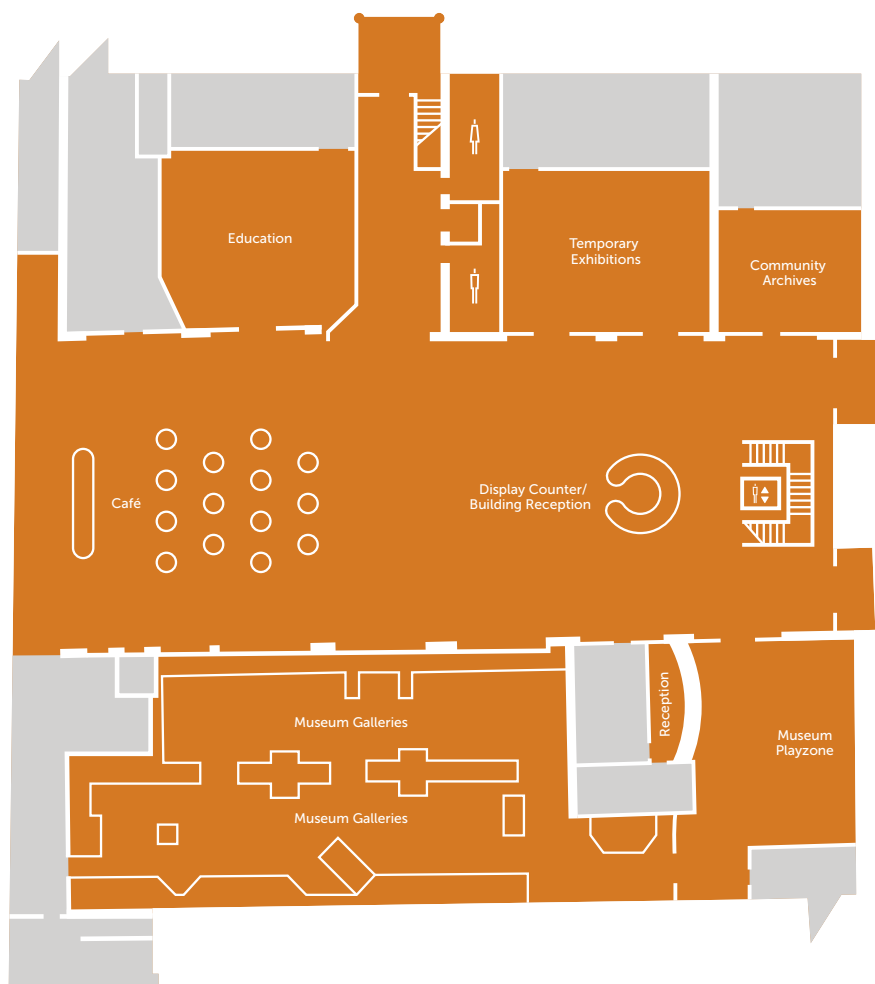

Ground Floor (GF)

- Building Reception
- Community Archive
- Exhibition Gallery
- Café
- Toilets
- Play zone
- Museum

Level One (L1)

- Offices

Finding Your Way Around The Mall

In this area is a café, a curved wooden display counter, and stairs which lead up to offices.

In the Mall area, you will also find toilets and the Glasshouse café. The café can be noisy and can have strong cooking smells. Toilets are located to the right of this area.



Finding Your Way Around The Community Archive

On the right-hand side of the hall,
is the museum's community archive
and temporary exhibition gallery.

The community archive is a room where
people can visit to look at books about
the history of Carrickfergus.

The community archive room has
drawers which you can open. There is
a television screen on the wall which
shows people talking about working in
a factory in Carrickfergus. There is the
sound of people talking coming from
the television.



Finding Your Way Around The Temporary Exhibition Gallery

Beside the community archive is the temporary exhibition gallery.

In it you might see art, photography, or a display about the history of the area. Sometimes there is a television screen on the wall which has both video and sound playing. This video will have something to do with the exhibition.



Finding Your Way Around Carrickfergus Museum

Museum Entrance

On your left-hand side as you enter the building, you will see the museum reception and main gallery. Above the doors is a sign that says: 'Carrickfergus Museum.'



Reception

When you go through these doors you will be in the museum reception. There might be someone behind the desk. You do not need tickets for the museum, so you do not have to speak to the person behind the desk, but they are there to help if you have any questions.



Play Zone

Beside the museum reception is The Play Zone. This area is for children to play with toys and puzzles. It looks a bit like a castle.



Finding Your Way Around Carrickfergus Museum

Gallery Entrance

When you walk past the Play Zone, you will come to the doors which lead into the museum gallery. Staff keep the doors closed to help to control the temperature in the museum. The museum is also a bit darker to help to protect the objects on display, but you will still be able to see them.



When you go through the doors, you will walk past two cannons, then you turn to the right. Most of the objects on display in the museum are behind glass. The objects will have a number beside them and information which tells you about them.

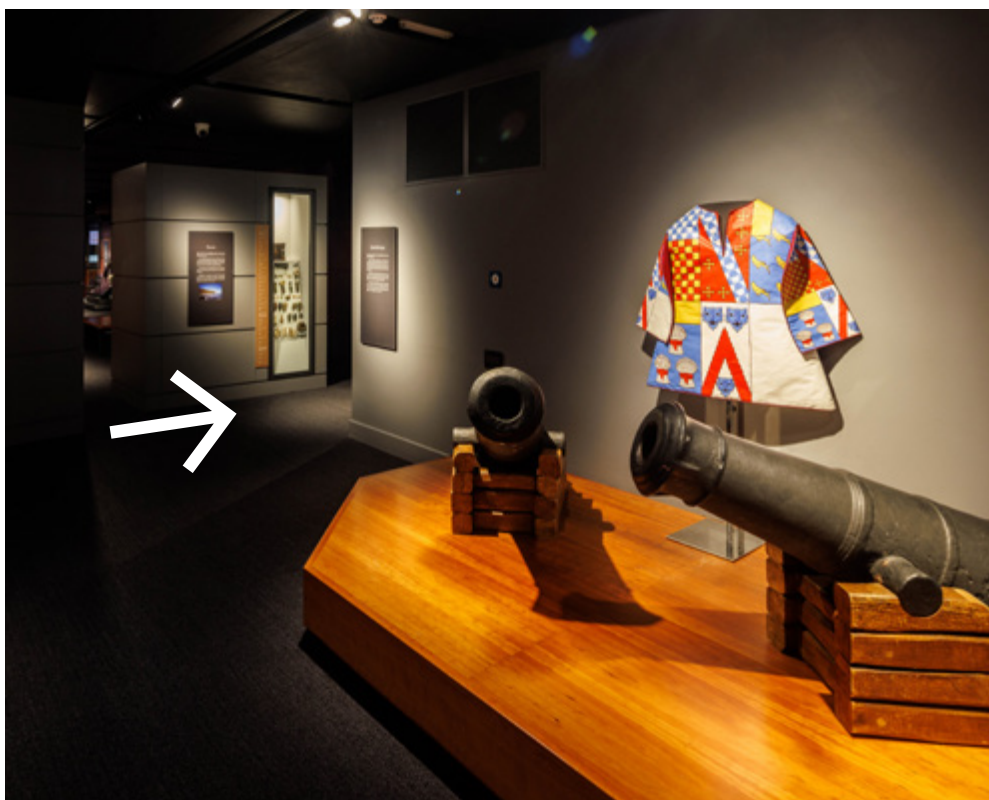

Finding Your Way Around Carrickfergus Museum

The Voice in the Museum

You will hear a voice talking in the museum. It is a film of a man who talks about Carrickfergus in Medieval times. There is a wooden bench that you can sit on to listen to the film if you would like to.

Maps

There is a desk with a screen above it showing different old maps of Carrickfergus. You can play with the maps by touching the screen on the desk. At the back there is another interactive screen with different maps of countries. You can work it by using the trackpad on the desk.



Finding Your Way Around Carrickfergus Museum

Seal Press

There are two old metal seals attached to the counter. You can ask at the reception desk for metal discs to use in the seals.



Leaving the Museum

There is a large red fire engine near the exit to the museum. To leave the museum, go back past the cannons and then go through the same doors that you came in through.



Opening Hours

Opening Hours

Monday	10am-4pm
Tuesday	10am-4pm
Wednesday	10am-4pm
Thursday	10am-4pm
Friday	10am-4pm
Saturday	10am-4pm
Sunday	Closed

Exceptional Closures

- Bank holidays
- Public holidays

Contact Details

Carrickfergus Museum
Carrickfergus Museum and Civic Centre
11 Antrim Street
Carrickfergus
BT38 7DG

Tel: 028 9335 8241

carrickfergusmuseums@midandeastantrim.gov.uk



Useful Information

We are committed to welcoming everyone to Mid and East Antrim Borough Council's facilities.

As well as producing this guide, we have signage in place around the building to help people with a range of needs find their way around.

We also run accessible classes and sessions for individuals with additional needs or disabilities, and for those who would prefer a quieter time to enjoy the centre.

For more details, please ask a member of staff.

Fire Alarms

If a fire alarm sounds, please make your way to the nearest fire exit. Staff will be there to help you.



Useful Information

Thank you for reading our guide. We are looking forward to seeing you soon.

All staff will be able to help you while in the building, or using any of the facilities if needed.

We hope this guide helps you to prepare for your visit, find your way around whilst here, and makes it easier for you to enjoy your time with us.

If You Have Questions

Should you have any questions about any part of our facilities, or your experience whilst visiting Carrickfergus Museum, please ask to speak to either the Heritage Officer or one of the Autism Champions.

Suggestions and Feedback

If you have any suggestions for improvement, again please ask to speak to the Heritage Manager or one of the Autism Champions.





Carrickfergus Museum

Carrickfergus Museum and Civic Centre
11 Antrim Street
Carrickfergus
BT38 7DG

Tel: 028 9335 8241
carrickfergusmuseums@midandeantrim.gov.uk

www.midandeantrim.gov.uk